

CALL (316) 686-0933
OFFICE / WAREHOUSE SPACE FOR LEASE

**Buck Alley
RENTALS**

For more information,
contact Buck
316.686.0933 office
316.655.1445 cell
buck@buckalleyrentals.com

4015 N. Woodlawn, Suite #2 Bel Aire, Kansas



60' x 30' Space Available: 1,800 sq ft
Finished Space: 900 sq ft
Warehouse: 900 sq ft
Gross Lease: \$1,100/month (\$7/sq ft)
Features:

- Reception and 3 offices
- Conference room—wet bar
- O/H door in heated warehouse
- Brick building
- Central HVAC in office area
- Trash/water/sewer paid

Space Available

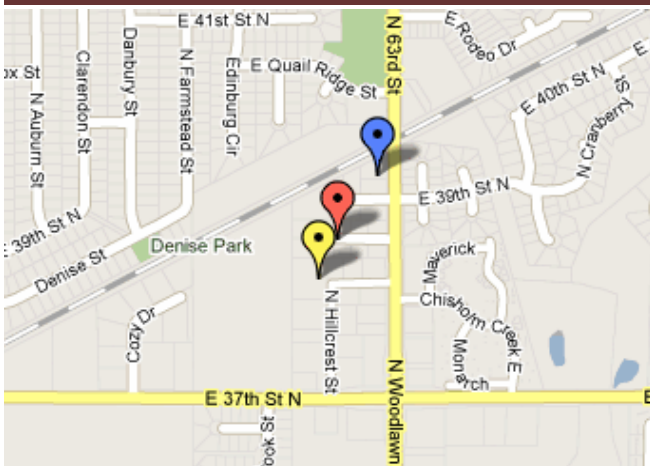
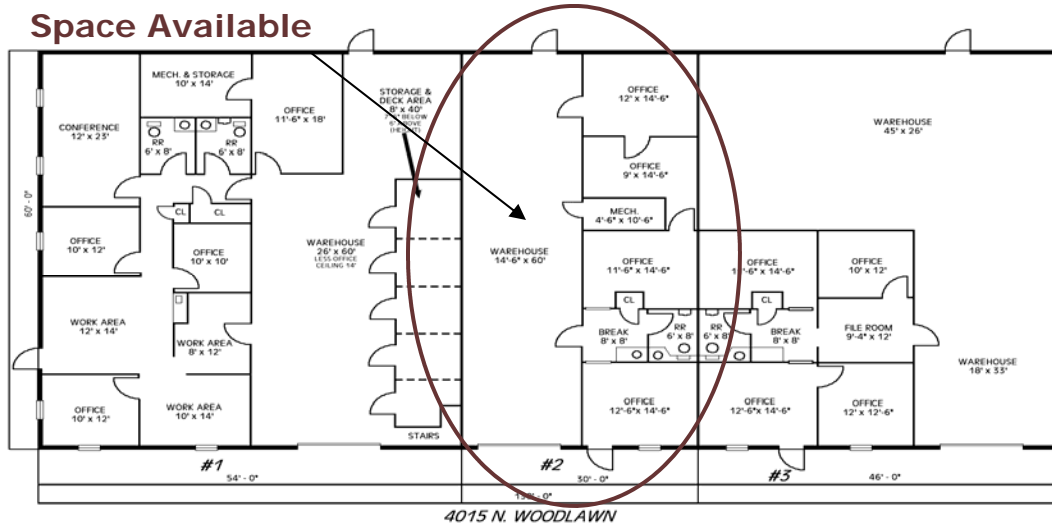

More Buck Alley Rentals

Bel Aire Plaza
4015, 4033, 4057, 4065, 4075
N. Woodlawn

Bel Aire Plaza II
3959, 3963, 3967, 3971, 3975,
3979, 3983 N. Woodlawn Ct.

Bel Aire Plaza III
3835 & 3919 N. Hillcrest

**Buck Alley
RENTALS**

3983 N Woodlawn Ct, Ste 1
P.O. Box 20384
Wichita, KS 67208
316.686.0933 phone
316.686.0939 fax
buck@buckalleyrentals.com
www.buckalleyrentals.com

FOR LEASE